



Valve Regulated Lead-Acid Rechargeable Battery



BP40-12

The battery is composed of positive plates, negative plates, AGM separators. Electrolyte is contained in absorbent glass-mat separators, safety valves, gas-tight ABS cover and container. Leak-proof regardless of which direction or position the battery is being used.

PERFORMANCE SPECIFICATIONS

Nominal Voltage(V).....	12 volts(6cells in series)
Nominal Capacity(Ah)	
20 hour rate F.V.(1.75V/cell) (2000mA to 10.50volts)	40Ah
10 hour rate F.V.(1.75V/cell) (3800mA to 10.50volts)	38Ah
5 hour rate F.V.(1.75V/cell) (6800mA to 10.50volts)	34Ah
1 hour rate F.V.(1.55V/cell) (24000mA to 9.30volts).....	24Ah
Approximate Weight.....	14300g(31.53lbs.)
Terminal	
Standard.....	Type B2
Optional.....	Type I1, I2
Internal Resistance (Fully Charged Battery).....	<8m Ω
Maximum Discharge Current For 5 sec.(A).....	600A
Maximum Charge Current(A).....	12A
Ambient Temperature	
Charge.....	0°C(32°F)~40°C(104°F)
Discharge.....	-20°C(-4°F)~50°C(122°F)
Storage.....	-20°C(-4°F)~40°C(104°F)
Vibration test:	
Frequency: 16.7Hz	
Amplitude: 4mm	
Vibrate the battery horizontally or vertically for 60 minutes. The battery have no abnormality.	
Case.....	ABS
Dimension(mm/inch)	
Length ±1.5mm.....	197/7.76
Width ±1.5mm.....	165/6.50
Container Height ±1.5mm.....	171/6.73
Total Height ±1.5mm.....	171/6.73
Application.....	Wheelchairs, Lawn Mowers, Electronic Medical Equipment, UPS, Golf-Carts.

BP40-12 Battery discharge characteristics (25°C/77°F)

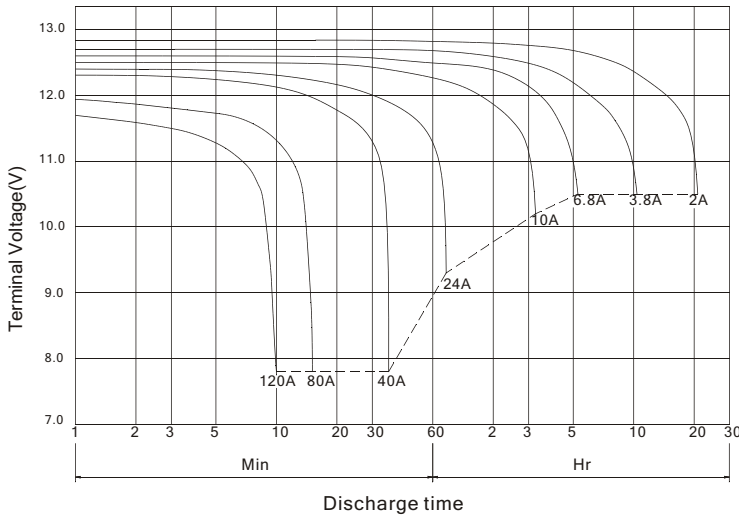

Battery Charging Characteristics

(Typical example of the charge characteristics for the standby use)

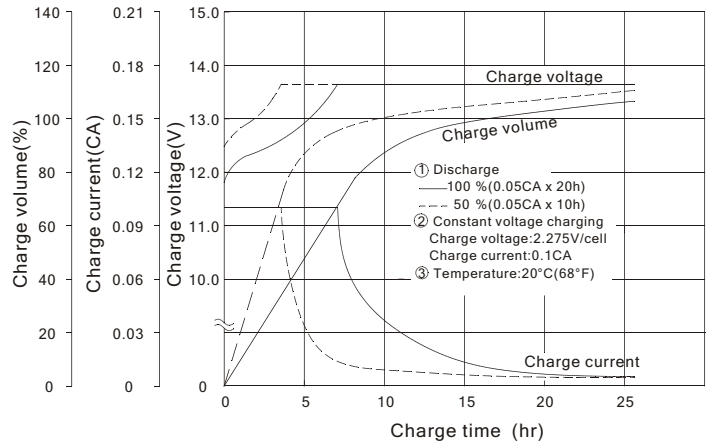

Effect of Temperature on Long Term Float Life

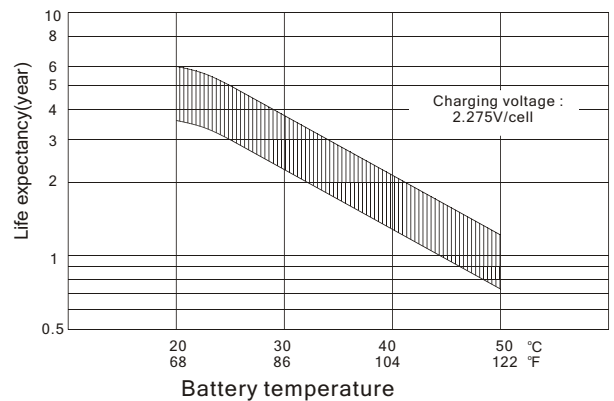

Charging Procedure

Application	Charging method	Charging Voltage at 20°C (V/cell)	Temperature compensation coefficient of charging voltage (mV/°C/cell)	Max. charging current (CA)	Charging time 0.1CA, 20°C (h)		Temp (°C)
					100% discharge	50% discharge	
For standby power Source	Constant voltage & Constant current charging (with current restriction)	2.25~2.30	-3	0.3	24	20	0~40 (32~104°F)
For cycle service		2.40~2.50	-4	0.3	16	10	

OUTER DIMENSIONS mm(inch)

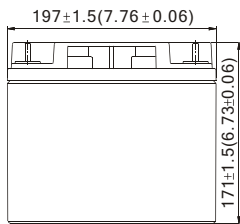
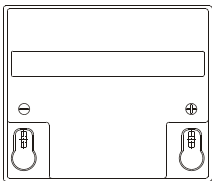

TERMINAL TYPE mm(inch)

● Terminal B2

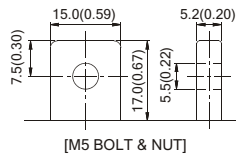

[M5 BOLT & NUT]

● Terminal I1

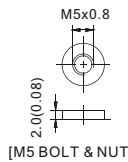

[M5 BOLT & NUT]

● Terminal I2

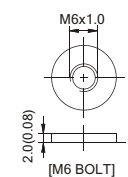

[M6 BOLT]

Constant power discharge characteristics at 25°C/77°F

Final Voltage	Discharge time								
	5Min	10Min	15Min	30Min	1Hr	3Hr	5Hr	10Hr	20Hr
10.80V	1446.2	1064.6	853.2	507.6	291.12	116.59	80.39	44.93	23.64
10.50V	1673.9	1153.4	892.4	526.9	299.86	118.93	81.60	45.60	24.00
10.20V	1778.5	1194.9	920.0	539.0	305.25	120.00	82.05	45.83	24.12
9.90V	1858.4	1223.5	941.2	546.5	308.91	120.83	82.33	45.96	24.19
9.60V	1920.0	1248.0	960.0	552.0	312.00	121.56	82.58	45.96	24.19

TERMINAL POSITION

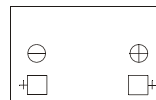

B.B. BATTERY CO., LTD.

Web Site: <http://www.bb-battery.com>

USA:
B&B BATTERY(USA) INC.
6415 RANDOLPH ST.COMMERCE,
CA,90040 U.S.A.
TEL:1-323-278-1900.1-800-278-8599
FAX:1-323-278-1268
E-Mail:sales@bb-battery.com

EUROPE:
B&B BATTERY(EUROPE) B.V.
3 WIJNGAARDVELD, 9300 AALST,BELGIUM
TEL:(00)32-53781567
FAX:(00)32-53781567
E-Mail:hansdevriese@bb-battery.com

CHINA FACTORY:
B.B. BATTERY CO., LTD.
CHENG DONG TRIAL AREA,HUANG GANG,
RAOPING, GUANG DONG,CHINA,515700
TEL:86-768-7601001-2
FAX:86-768-7601469
E-Mail:maggy@bb-battery.com

HONG KONG:
NATIONAL TRADING LTD.
TEL:852-2301-3800
FAX:852-2739-1182
E-Mail:bbhk@hkstar.com

JAPAN:
B&B BATTERY(JAPAN) CO., LTD.
1375-11 NARAHARA-MACHI,HACHIOJI,
TOKYO 193-0803,JAPAN.
TEL:81-426-25-6375
FAX:81-426-25-6375
E-Mail:miyata@bb-battery.com

TAIWAN:
B.B. BATTERY(TAIWAN) CO., LTD.
TEL:886-6-502-5150
FAX:886-6-589-8087
E-Mail:maggy@bb-battery.com

